

TECHNICAL GUIDE  
&  
PARTS CATALOGUE

Cal. VD57B

ANALOGUE QUARTZ

CAL.No.		VD57B
Item		
Movement		
Movement size	Outside diameter	$\phi$ 29.50mm(12H-6H) × 26.00mm
	Casing diameter	$\phi$ 28.80mm(12H-6H)
	Total height	4.57mm
Time indication		3 hands (hour,minute,second) Chronograph (minute, second, 1/10 second) Calendar
Driving system		Two pole stepping motor Step motor 3 pieces
Additional mechanism		Electronic circuit reset switch Second setting device <ul style="list-style-type: none"> <li>▪ Time Indicated by the hour ,minute, second and Calendar</li> <li>▪ Stopwatch Up to 1minutes in 1/10 second (2 second per round) Up to 60 minutes in 1 second split time</li> </ul>
Antimagnetic		$\geq$ 1600 A/m
Accuracy		Less than $\pm 20$ seconds : Monthly rate at normal temperature range
Battery		SR920SW (SEIZAIKEN) Silver oxide battery $\phi$ 9.5 × t 2.0 mm Battery life is approximately 2 years
Measuring gate by quartz tester		Use 10-second gate * Set the winding stem with crown at the normal position
Jewels		0 Jewel
Regular hands unbalance		
Second		Less than 0.07 $\mu$ N•m (7mg•mm)
Minute		Less than 0.60 $\mu$ N•m (60mg•mm)
Hour		Less than 0.50 $\mu$ N•m (50mg•mm)
Chrono minute/second		Less than 0.05 $\mu$ N•m (5mg•mm)

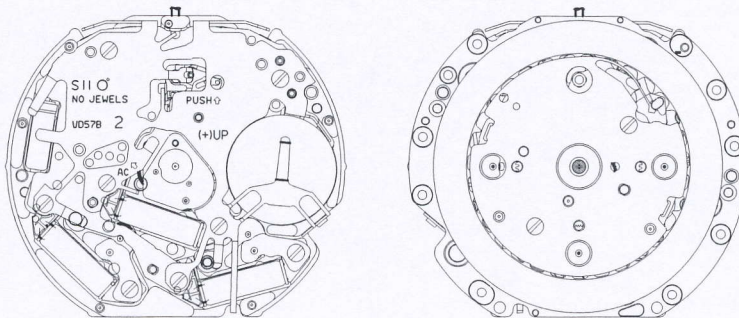

Disassembling procedures Figs. : ① → ⑤⑥

Reassembling procedures Figs. : ⑤⑥ → ①

Lubricating : Types of oil Oil quantity

Moebius A

Normal quantity

Moebius V

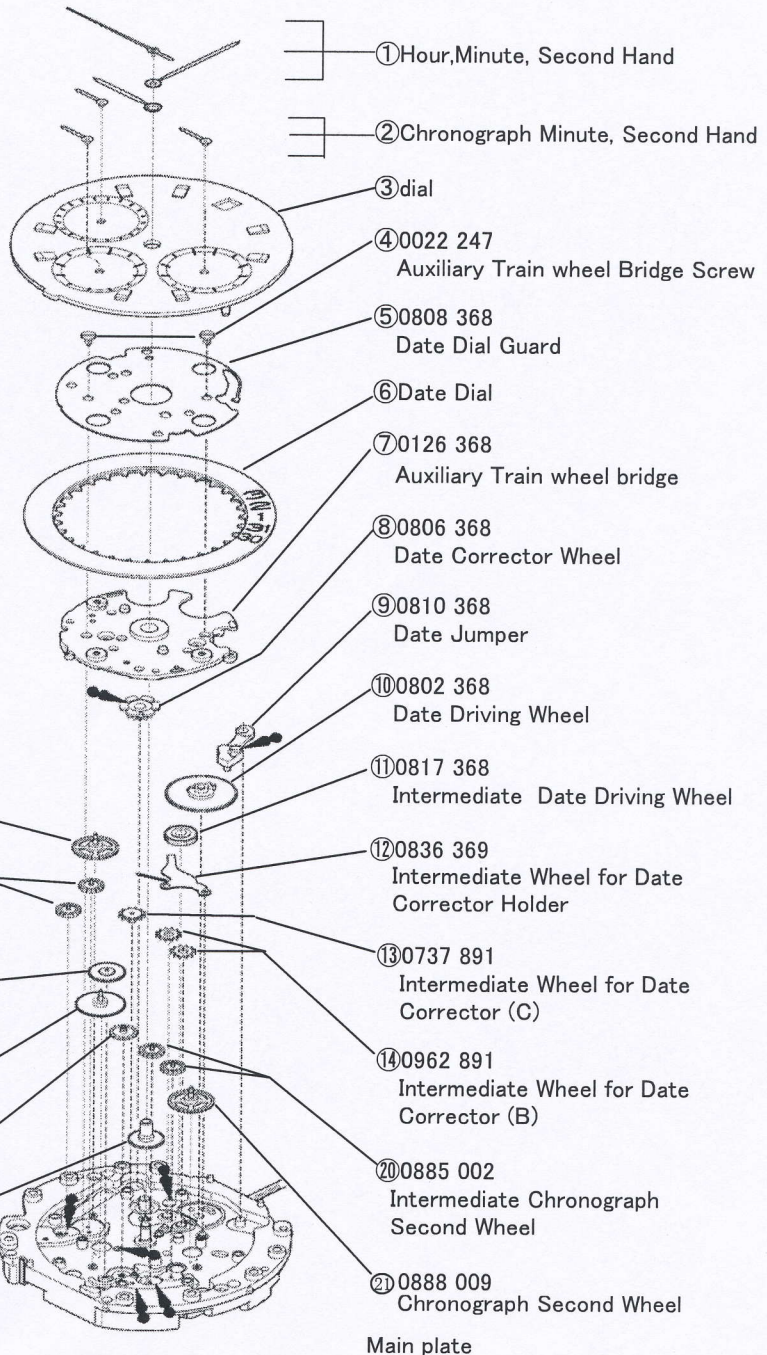

**\* All parts code are subject to change without notice.**



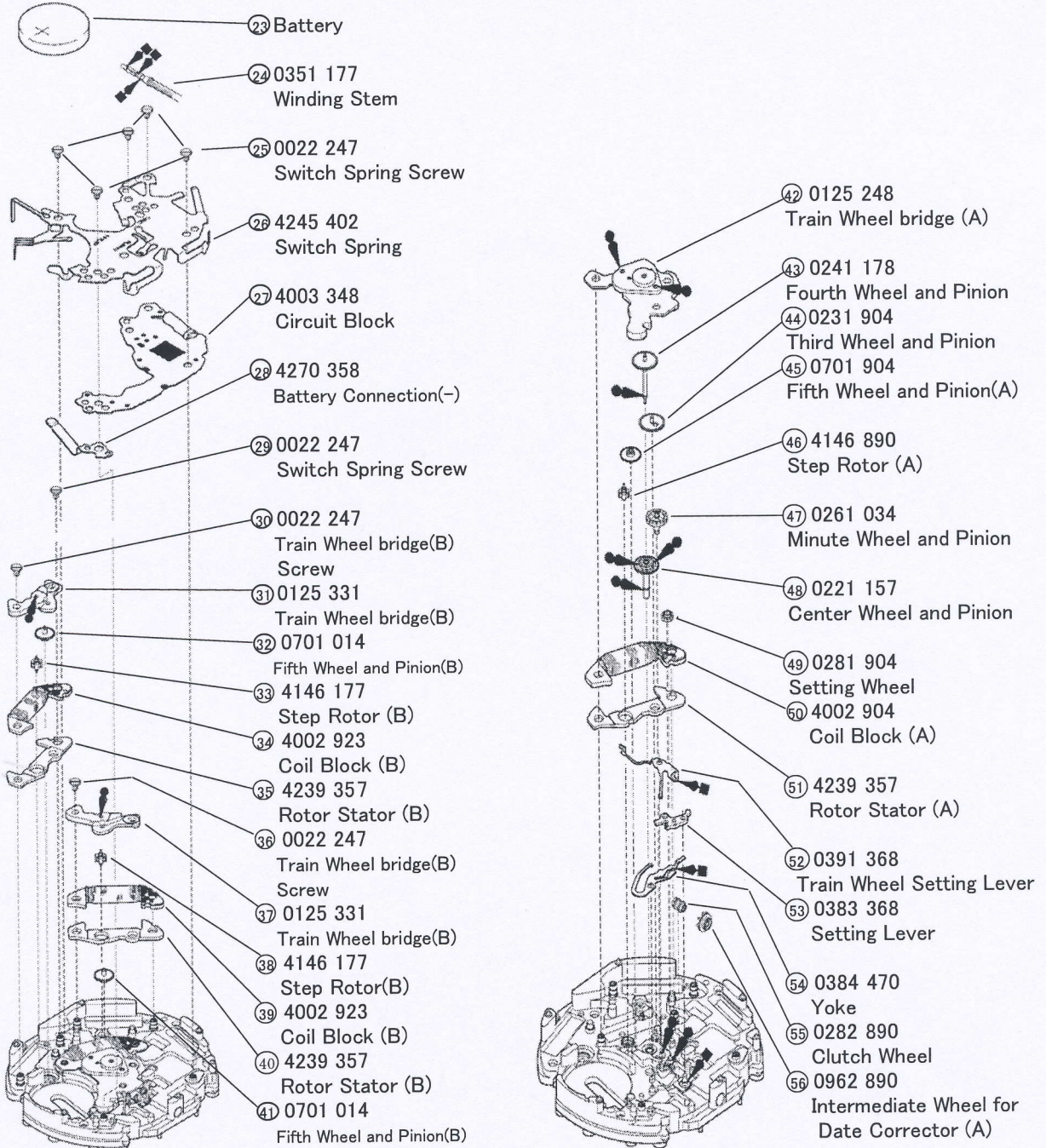

Main plate

**\* All parts code are subject to change without notice.**

Remarks:

⑥ Date dial

Part code	Position of crown	Position of date frame	Color of figure	Color of background
0878 220	3 H	3 H	Black	White
0878 221	3 H	3 H	White	Black

**\* All parts code are subject to change without notice.**